

RYCO FILTERS

FITTING INSTRUCTIONS FOR RYCO CABIN FILTER RCA196M.



**2005-08 SUBARU FORESTER, 2003-04 IMPREZA, 2006-07 IMPREZA OUTBACK
SPORT, IMPREZA 2.5 RS, IMPREZA WRX STi, 2004-07 IMPREZA WRX.**

(Filter is located behind glove box)



REMOVE SCREWS FROM TOP &
BOTTOM OF GLOVE BOX,
REMOVE GLOVE BOX.

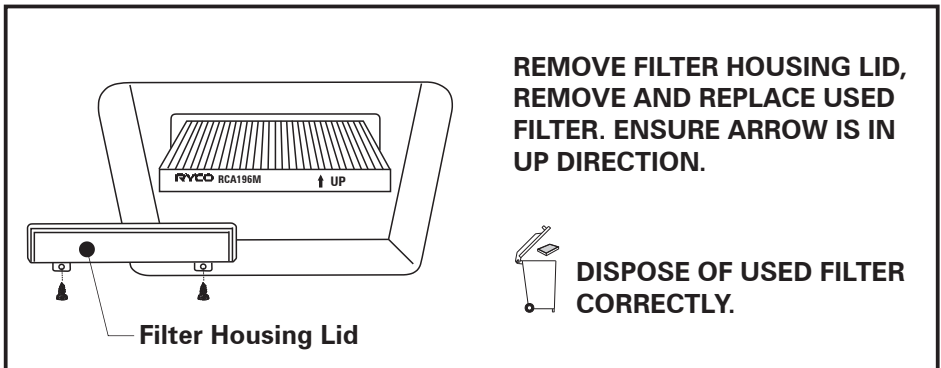

REMOVE FILTER HOUSING LID,
REMOVE AND REPLACE USED
FILTER. ENSURE ARROW IS IN
UP DIRECTION.

DISPOSE OF USED FILTER
CORRECTLY.

TOOL BOX = PHILLIPS HEAD or STANDARD SCREW DRIVER.

RYCO Group Pty Ltd
29 Taras Ave Altona
North Victoria 3025
Australia
www.rycofilters.com.au

RYCO Group- A division of
GUD (NZ) Holdings Limited.
19 Bell Avenue, Otahuhu,
Auckland 1060, New Zealand
www.ryco.co.nz